

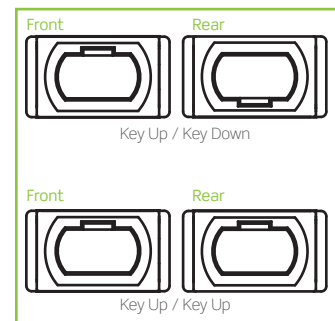

## SDX ADAPTER PLATES

- Work with SDX Enclosures, including 2000i, 1000i, 500i, and wall-mount
- Captive push/pull fasteners allow for quick, tool-free installation and removal
- Precision-molded LC and SC adapter plate colors designate fiber type, per TIA standards
- Available in 6- to 24-fiber plates for LC, SC, and ST
- Available in 72- to 192-fiber plates for MTP™
- MTP and LC adapter plates with shutters available by custom order
- 6-position QuickPort™ Adapter Plates (item V) accept all QuickPort modules



## SDX RACK-MOUNT ENCLOSURE CAPACITY

1RU FOR 2000i, 1000i & 500i	2RU FOR 2000i, 1000i & 500i	3RU FOR 1000i	3RU FOR 500i	4RU FOR 2000i & 1000i
Holds up to 3 adapter plates	Holds up to 6 adapter plates	Holds up to 9/12 adapter plates	Holds up to 12 adapter plates	Holds up to 12/15 adapter plates
6-pk Dplx LC = up to 36-fibers 6-pk Quad LC = up to 72-fibers 3-pk Dplx SC = up to 18-fibers 6-pk Dplx SC = up to 36-fibers 6-pk ST = up to 18-fibers 8-pk ST = up to 24-fibers	6-pk Dplx LC = up to 72-fibers 6-pk Quad LC = up to 144-fibers 3-pk Dplx SC = up to 36-fibers 6-pk Dplx SC = up to 72-fibers 6-pk ST = up to 36-fibers 8-pk ST = up to 48-fibers	6-pk Dplx LC = up to 108/144-fibers 6-pk Quad LC = up to 216/288-fibers 3-pk Dplx SC = up to 54/72-fibers 6-pk Dplx SC = up to 108/144-fibers 6-pk ST = up to 54/72-fibers 8-pk ST = up to 72/96-fibers	6-pk Dplx LC = up to 144-fibers 6-pk Quad LC = up to 288-fibers 3-pk Dplx SC = up to 72-fibers 6-pk Dplx SC = up to 144-fibers 6-pk ST = up to 72-fibers 8-pk ST = up to 96-fibers	6-pk Dplx LC = up to 144/180-fibers 6-pk Quad LC = up to 288/360-fibers 3-pk Dplx SC = up to 72/90-fibers 6-pk Dplx SC = up to 144/180-fibers 6-pk ST = up to 72/90-fibers 8-pk ST = up to 96/120-fibers

## SDX WALL-MOUNT ENCLOSURE CAPACITY

MINI	SMALL	MEDIUM	LARGE
Holds up to 1 adapter plate	Holds up to 2 adapter plates	Holds up to 4 adapter plates	Holds up to 12 adapter plates
6-pk Dplx LC = up to 12 fibers 6-pk Quad LC = up to 24 fibers 3-pk Dplx SC = up to 6 fibers 6-pk Dplx SC = up to 12 fibers 6-pk ST = up to 6 fibers 8-pk ST = up to 8 fibers	6-pk Dplx LC = up to 24 fibers 6-pk Quad LC = up to 48 fibers 3-pk Dplx SC = up to 12 fibers 6-pk Dplx SC = up to 24 fibers 6-pk ST = up to 12 fibers 8-pk ST = up to 16 fibers	6-pk Dplx LC = up to 48 fibers 6-pk Quad LC = up to 96 fibers 3-pk Dplx SC = up to 24 fibers 6-pk Dplx SC = up to 48 fibers 6-pk ST = up to 24 fibers 8-pk ST = up to 32 fibers	6-pk Dplx LC = up to 144 fibers 6-pk Quad LC = up to 288 fibers 3-pk Dplx SC = up to 72 fibers 6-pk Dplx SC = up to 144 fibers 6-pk ST = up to 72 fibers 8-pk ST = up to 96 fibers